

EXISTING
RYE ST. BRIDGE
NAPOLEON, OHIO
OCT. 19, 1981

N  Scale 1"=2'

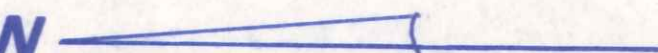
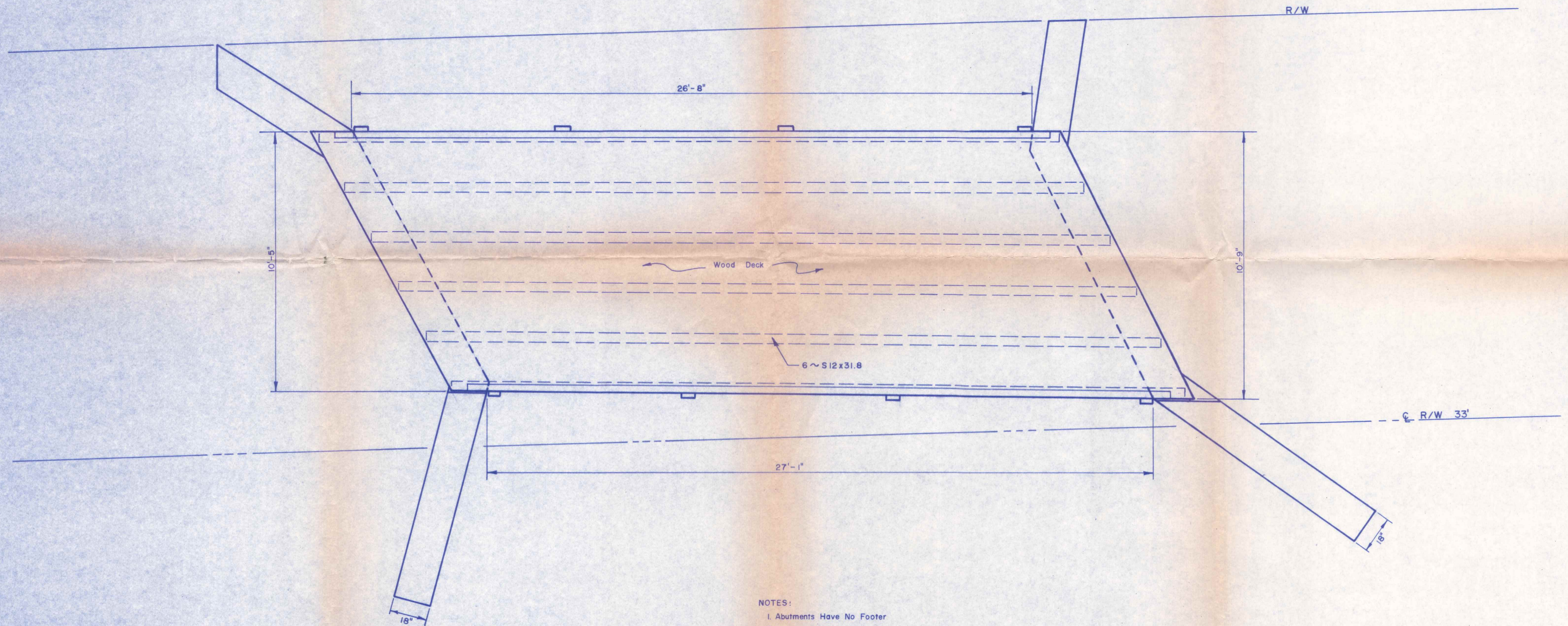

- NOTES:
1. Abutments Have No Footer
 2. Southwest Wingwall Separated From South Abutment

DRWN. BY J.A.H.

R/W

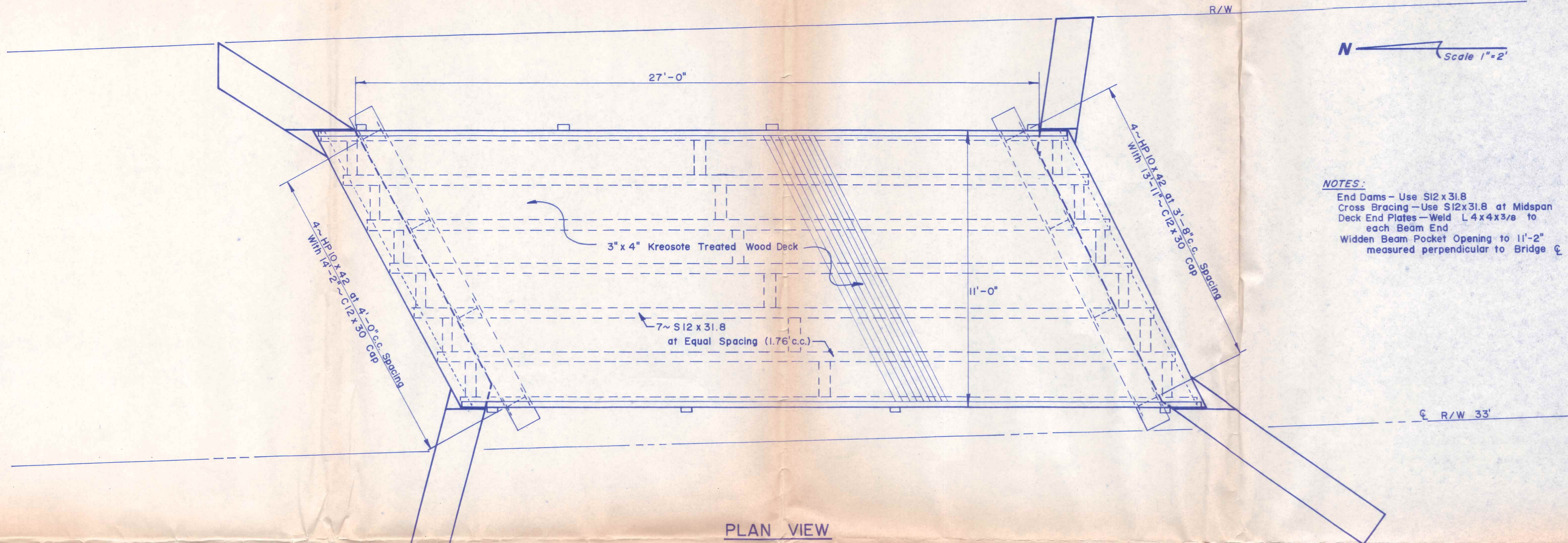

PLAN VIEW

NOTES:
 End Dams - Use S12x31.8
 Cross Bracing - Use S12x31.8 at Midspan
 Deck End Plates - Weld L4x4x3/8 to each Beam End
 Widden Beam Pocket Opening to 11'-2" measured perpendicular to Bridge C

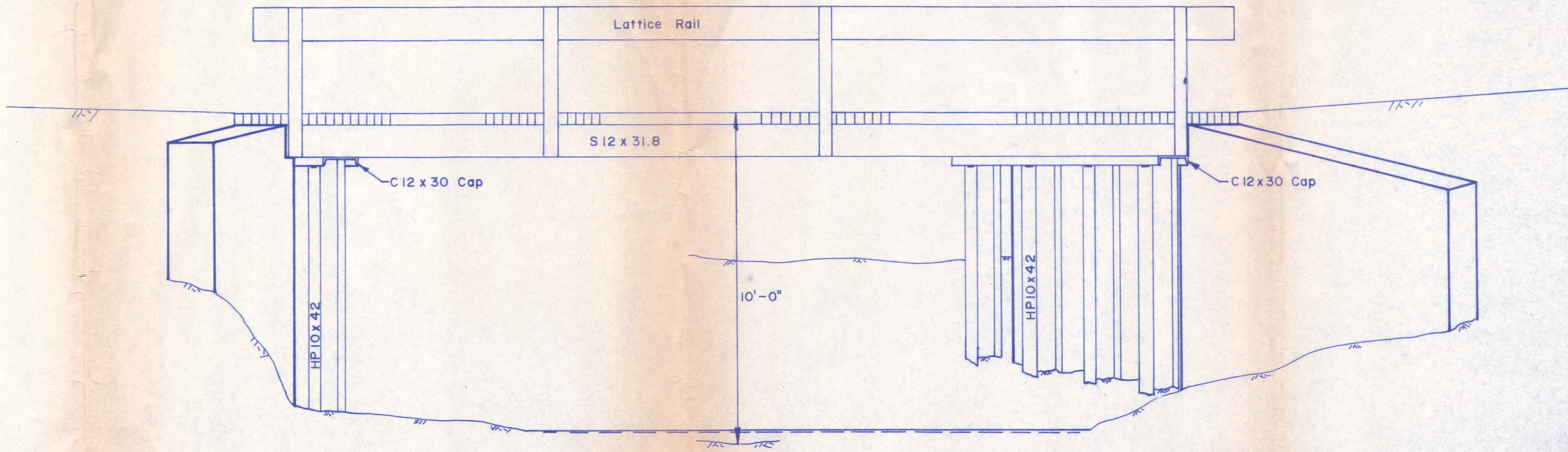

PROFILE VIEW



RYE ST. BRIDGE
 RECONSTRUCTION
 OCT. 19, 1981
 NAPOLEON, OHIO
 DRWN. BY J.A.H.